

Jabra GN

The Jabra Engage Series Engineered to be the world's most powerful professional wireless headsets*

The **Jabra Engage Series** is an entirely new class of DECT wireless professional headsets engineered to boost customer satisfaction.

Industry-leading professional wireless performance. Better customer connections.

Provides superior wireless connectivity to a range of up to 490ft. Enables 3x more users to operate in the same office space – with no loss in connection quality.¹

Crystal-clear calls. Enhance the customer experience.

Advanced noise-cancelling microphone and enhanced speakers deliver crystal-clear calls even in noisy offices. Meets Skype for Business Open Office requirements.²

More talk time, less interruption. Increase productivity.

Up to 13 hours talk time³ and a busylight that acts as a do-not-disturb sign for colleagues.

Any call, from any device. Increase availability for calls.

Connect to up to five devices² simultaneously, increasing your team's availability for customer calls. Can connect to 2 USB devices (softphone and/or desk phone), 2 Bluetooth® devices and 1 analog desk phone.

Choice of wearing styles. Support different workstyles.

With a choice of stereo, mono and lightest-in-category convertible models, there's a Jabra Engage for everyone.

At a glance

Jabra Engage Series wireless headsets

- Up to 490ft range
- 3x wireless density¹
- Advanced noise-cancelling microphone
- Enhanced speakers with intelligent volume control
- Up to 13 hours talk time³
- Integrated busylight



Works with



* Relates to Jabra Engage 75/65 Stereo and Mono variants.

February 19, 2018. See facts on [Jabra.com/commercial-claims](https://www.jabra.com/commercial-claims)

¹ Find details on page 2 ² Variant dependent ³ Dependent on usage

Getting started

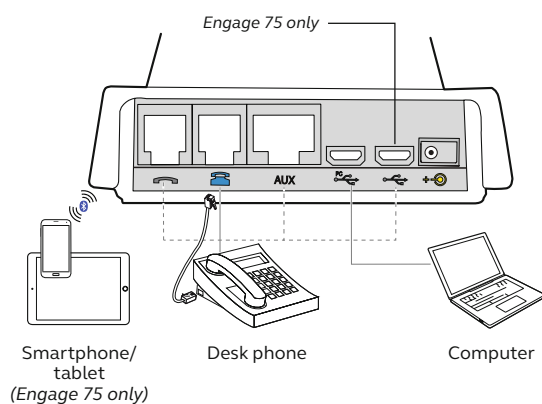

First, connect the desk phone and PC cables to the base. For information on your specific phone, refer to <http://www.jabra.com/compatibilityguide>

Connect to power

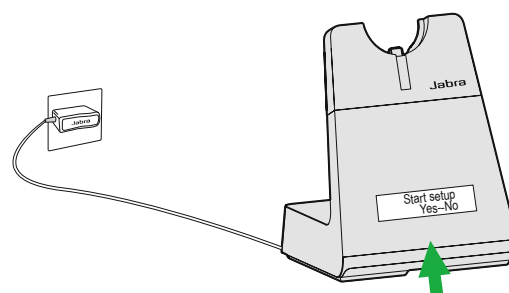

Then plug the base into a power supply, and then scroll to the Setup Wizard in the menu (Engage 75) or follow the voice-guided menu to get connected.



Features	Jabra Engage 75 Stereo/Mono	Jabra Engage 75 Convertible	Jabra Engage 65 Stereo/Mono	Jabra Engage 65 Convertible
Wireless capacity NA- wideband ¹	80	80	80	80
Wireless capacity NA- narrowband ²	130	130	130	130
Wireless range (up to - feet)	490	330	490	330
Talk time (up to - hours) ³	13	9	13	9
Fast charge - from 0-40% (minutes)	30	30	30	30
Emergency charging	Yes	Yes	Yes	Yes
Connectivity - how many devices	5 ⁴	5 ⁴	2 ⁵	2 ⁵
Wireless technology	DECT	DECT	DECT	DECT
Secure DECT (level)	C	C	C	C
Intelligent volume control (speech level normalization and balanced voice)	Yes	Yes	Yes	Yes
User sound protection (PeakStop™, Noise@Work, Acoustic Shock)	Yes	Yes	Yes	Yes
Directional noise cancelling microphone	Yes	Yes	Yes	Yes
Microphone (G-MOS, Tx, CC)	4.3	3.8	4.3	3.8
Speaker (P-MOS, Rx, Silent)	4.4	3.9	4.4	3.9
Meets Skype for Business Open Office requirements	Yes	No	Yes	No
Boom arm adjustable	270°	360°	270°	360°
Busylight	Yes	Yes	Yes	Yes
Wearing styles	Stereo and mono ⁶ versions	Choice of earhook, neckband or headband	Stereo and mono ⁷ versions	Comes with earhook ⁸
Headset weight (g)	Stereo: 90/Mono: 64	18	Stereo: 83/Mono: 57	18

Compatibility

For compatibility information go to **Jabra.com**



¹ DECT capacity, number of theoretical users in wideband. Actual numbers may vary

² DECT capacity, number of theoretical users in narrowband. Actual numbers may vary ³ Dependent on usage

⁴ Can connect to 2 USB devices (softphone and/or desk phone), 2 Bluetooth® devices and 1 analog desk phone

⁵ Can connect to 1 USB device (softphone or desk phone) and 1 analog phone

⁶ Engage 75 Mono: comes with neckband accessory ⁷ Engage 65 Mono: neckband is available as an accessory

⁸ Engage 65 Convertible: headband and neckband are available as accessories ⁹ Softphone certified, desk phone in progress